

| | |
|-----------------------|-------------|
| CATALOG NUMBER | TYPE |
| PROJECT | |

LINEAR SYSTEM – HALOGEN TRACK FIXTURE

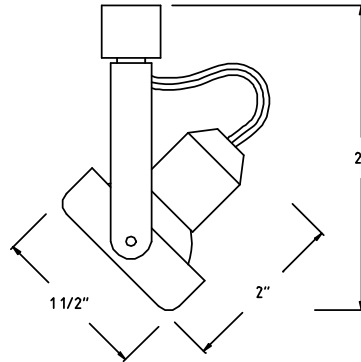

MODEL SF-211



| Ordering Matrix | | | |
|------------------------|--------|--------|-----------------|
| Model | Series | Finish | Accessories |
| [] | [] | [] | |
| SF | 211 | BK WT | See table below |

Ordering Example (model – series – finish + optional accessory): SF-211-WT

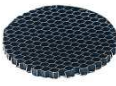
| Product Details | | Specification Features |
|------------------------|---|---|
| Description: | Low voltage track head utilizing precise MR11 lamps. Specifically designed small sized fixture for use with the W.A.C. Linear System. | <ul style="list-style-type: none"> The supplied clear glass lens can be replaced with one lens accessory such as a colored dichroic lens, UV filter lens, etc. Can use 12 volt or 24 volt lamps, dependant on Linear System transformer. Transformer and Linear System track is ordered separately. |
| Materials: | All metal track head with polycarbonate track adaptor. Bi-pin ceramic socket with 18 gauge Teflon insulated wires and fiberglass sleeves. Clear glass lens. Spring tension ring to retain lens. | |
| Aiming: | 350° horizontal rotation and 90° vertical aiming. Yoke style aiming allows easy and fine adjustment to the desired angle. The aiming screw may be tightened to firmly hold vertical aiming angle. | |
| Lamping: | MR11 lamp, 35w max. The SF-211 is suitable for 12v or 24v lamps. Lamps sold separately. | |
| Finish: | Abrasion resistant Black (BK) or White (WT) paint finish. | |
| Listing: | UL & CUL Listed. 5 year W.A.C. Lighting product warranty. | |

| Accessory Lenses (ordered separately): | | | |
|---|--|---|--|
| LENS-11-UVF UV Filter Lens  | LENS-11-COLOR Colored Lenses AMB = Amber BLU = Blue GRN = Green RED = Red YEL = Yellow  | LENS-11-DIC-COLOR Dichroic Lenses AMB = Amber BLU = Blue GRN = Green RED = Red YEL = Yellow  | |
| LENS-11-HCL Honeycomb Louver  | LENS-11-SPR Spread Lens  | LENS-11-BEL Beam Elongating Lens  | |