

CATALOG NUMBER	TYPE
PROJECT	

6" LINE VOLTAGE DOWNLIGHTS

R-657

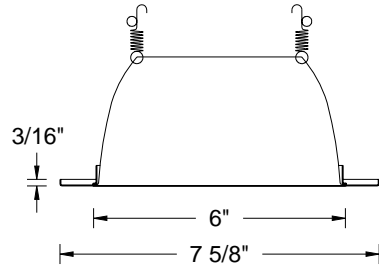







Ordering Matrix		
Series	Model	Finish(Reflector/Trim)
[]	[]	[]
R	657	BN CB CL/WT

Ordering Example (series – model number – finish): R-657-BN

Product Details	
Description:	Recessed trim with open reflector. For use with R-6XX series Line voltage downlights.
Materials:	Durable stamped metal construction. Secured to lampholder bracket by steel spring. Provided with foam rubber gasket around outer perimeter.
Lamping	Utilizes medium base incandescent lamps. Incandescent lamps are rated for up to 150W watts max. Lamps are ordered separately.
Finish:	Abrasion resistant powder coat painted or plated metal finish. Available in Clear reflector. Trim is available in Brushed Nickel (BN), Copper Bronze (CB) or White(WT).
Listing:	UL & CUL Listed. Suitable for damp locations.

Specification Features
<ul style="list-style-type: none"> • Handles surfaces up to 1" • 5 year W.A.C. Lighting product warranty.

Compatible Housings(Sold separately)

<p>R-600D-N-A</p> <p>NON-IC Rated. Air tight. New Construction 150W PAR38,150W R40</p>	 A cylindrical metal housing with a mounting bracket and a small rectangular component on the side.	<p>R-601D-R-A</p> <p>NON-IC Rated. Air tight. Remodel housing. 150W PAR38,150W R40</p>	 A cylindrical metal housing with a mounting bracket and a small rectangular component on the side, similar to R-600D-N-A but with a different mounting bracket.
<p>R-602D-N-ICA</p> <p>IC Rated. Air tight. New Construction 75W PAR38,75W R40</p>	 A cylindrical metal housing with a mounting bracket and a small rectangular component on the side.	<p>R-603D-R-ICA</p> <p>IC Rated. Air tight. Remodel housing. 75W PAR38,75W R40</p>	 A cylindrical metal housing with a mounting bracket and a small rectangular component on the side, similar to R-601D-R-A but with a different mounting bracket.
<p>R-660S-N-A</p> <p>NON-IC Rated. Air tight. New Construction Shallow housing. 75W PAR38</p>	 A cylindrical metal housing with a mounting bracket and a small rectangular component on the side.	<p>R-661S-R-A</p> <p>NON-IC Rated. Air tight. Remodel shallow housing. 75W PAR38</p>	 A cylindrical metal housing with a mounting bracket and a small rectangular component on the side, similar to R-660S-N-A but with a different mounting bracket.

W.A.C. reserves the right to change details that do not affect overall function and performance.