

**PALOMA SPOT – METAL HALIDE TRACK HEAD**

**SERIES WTK-502**

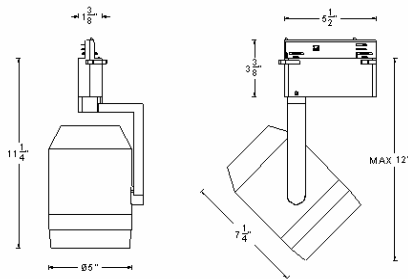

WTK-502-20E/39E

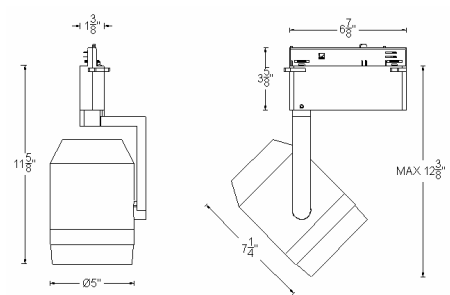

WTK-502-70E

**Ordering Matrix**

Model	Beam Angle	Wattage	Finish
[ ]	[ ]	[ ]	[ ]
WTK-502	SP = 15° NF = 25° FL = 40°	20E = 20W 39E = 39W 70E = 70W	BK = Black WT = White PT = Platinum

Ordering Example (model – beam-wattage- finish) : WTK-502-FL-39E-PT

**Product Details**

**Description:** Metal Halide track head using T4 HID lamps. Model WTK-502 Designed for use on WAC ARCHITECTURAL tracks(120V). Adaptable to other manufacturer's track. (Consult factory for specific brands).

**Materials:** Die-cast aluminum fixture, cap ring.  
Clear wove 1/8 inch tempered glass lens included.

Ballast:	20W	39W	70W
( VS ) ANSI # :	M156	M130	M98 / 139
Line Current :	0.20A	0.38A	0.64A
Input Power :	23W	45W	77W
Input Voltage :	120V	120V	120V
Power Factor :	> 90%	> 90%	> 90%
Sound Rating :	A	A	A

**Socket:** Ceramic Bi-Pin HID G8.5

**Aiming:** 365° horizontal rotation and 180° vertical aiming to secure the aiming adjustment on horizontal .

**Lamping:** Re-lamps from the front using T4 HID lamps. 20W, 39W or 70W as specified on the fixture. Lamp not included

**Finish:** Powder coat paint finish.  
Available in Black (BK), White (WT), Platinum (PT).

**Listing:** UL & CUL Listed. Patent Pending.

**Specification Features**

- Die-cast aluminum fixture.
- Spring sheet within lens cap allows 4 captive accessories to be held securely.
- The track head utilizes on the WAC ARCHITECTURAL style track (120V).
- 5 year product warranty.

## Compatible Accessories –USE SIZE 30

• **Dichroic Lens**  
LENS-30-DIC-COLOR

• **UV Filter**  
LENS-30-UV

• **IR Filter**  
LENS-30-IR

• **UV- IR Filter**  
LENS-30-UI

• **Beam Elongator**  
LENS-30-BEL

• **Beam Soft/Beam Spread Lens**  
LENS-30-BSL / LENS-30-SPR

• **Block Screen**  
LENS-303-BS/ LENS-304-BS/ LENS-305-BS

• **Hood (for wall-washing)**  
HOOD-30-BK

• **Cross Louver**  
LENS-302-CRL

• **Snoot**  
LENS-30-SNOOT

• **Honeycomb Louver**  
LENS-302-HCL

## Photometry

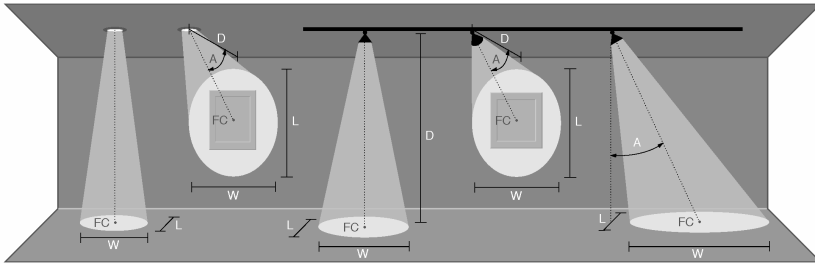

D Distance To Fixture From Wall Or Floor  
FC Initial Footcandle Level At Center Of Beam  
L Beam Length (where candlepower drops to 50% of maximum)  
W Beam Width (where candlepower drops to 50% of maximum)

WTK 502S T4 20W 15 DEG			
0° Aiming Angle			
D(ft)	FC	L	W
6	255	1.3	1.3
9	113	2.0	2.0
12	64	2.6	2.6
15	41	3.3	3.3
45° Aiming Angle			
D(ft)	FC	L	W
6	90	2.7	1.9
9	40	4.0	2.8
12	23	5.4	3.7
15	14	6.7	4.7

WTK 502S T4 39W 15 DEG			
0° Aiming Angle			
D(ft)	FC	L	W
6	587	1.3	1.3
9	261	1.9	1.9
12	147	2.5	2.5
15	94	3.2	3.2
45° Aiming Angle			
D(ft)	FC	L	W
6	208	2.6	1.8
9	92	3.8	2.7
12	52	5.1	3.6
15	33	6.4	4.5

WTK 502S T4 70W 15 DEG			
0° Aiming Angle			
D(ft)	FC	L	W
6	950	1.5	1.5
9	422	2.3	2.3
12	238	3.1	3.1
15	152	3.8	3.8
45° Aiming Angle			
D(ft)	FC	L	W
6	336	3.1	2.2
9	149	4.7	3.3
12	84	6.3	4.3
15	54	7.8	5.4

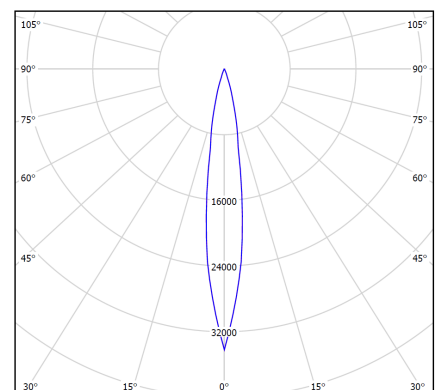
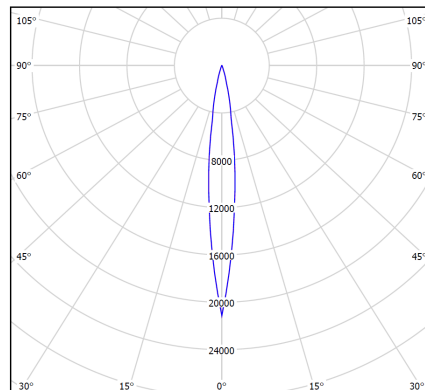
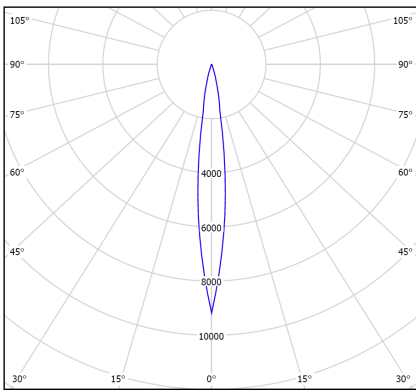

WTK 502N T4 20W 20 DEG			
0° Aiming Angle			
D(ft)	FC	L	W
6	215	1.7	1.7
9	96	2.6	2.6
12	54	3.4	3.4
15	34	4.3	4.3
45° Aiming Angle			
D(ft)	FC	L	W
6	76	3.5	2.4
9	34	5.2	3.6
12	19	7.0	4.8
15	12	8.7	6.0

WTK 502N T4 39W 20 DEG			
0° Aiming Angle			
D(ft)	FC	L	W
6	128	4.4	4.4
9	57	6.6	6.6
12	32	8.8	8.8
15	20	11.0	11.0
45° Aiming Angle			
D(ft)	FC	L	W
6	45	10.2	6.2
9	20	15.3	9.4
12	11	20.4	12.5
15	7	25.5	15.6

WTK 502N T4 70W 25 DEG			
0° Aiming Angle			
D(ft)	FC	L	W
6	469	2.6	2.6
9	208	3.8	3.8
12	117	5.1	5.1
15	75	6.4	6.4
45° Aiming Angle			
D(ft)	FC	L	W
6	166	5.3	3.6
9	74	8.0	5.4
12	41	10.7	7.2
15	27	13.4	9.0

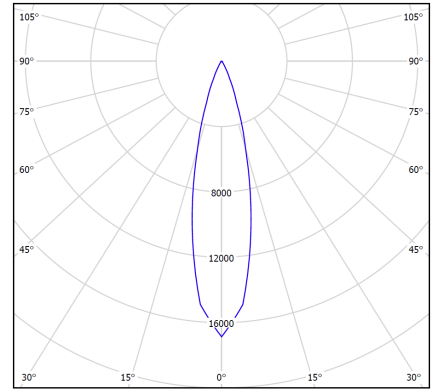
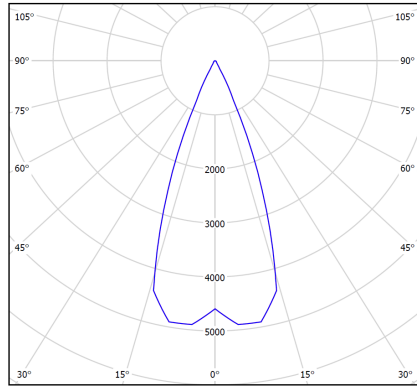
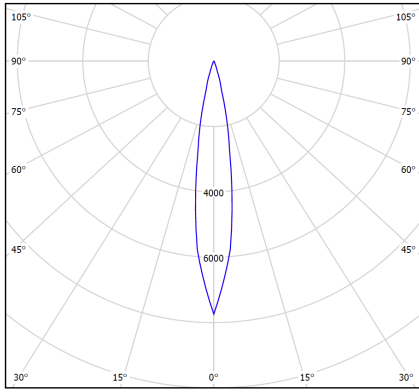

WTK 502F T4 20W 40 DEG			
0° Aiming Angle			
D(ft)	FC	L	W
6	80	3.5	3.5
9	36	5.2	5.2
12	20	7.0	7.0
15	13	8.7	8.7
45° Aiming Angle			
D(ft)	FC	L	W
6	28	7.6	4.9
9	13	11.4	7.4
12	7	15.2	9.9
15	5	19.0	12.3

WTK 502F T4 39W 40 DEG			
0° Aiming Angle			
D(ft)	FC	L	W
6	139	4.2	4.2
9	62	6.4	6.4
12	35	8.5	8.5
15	22	10.6	10.6
45° Aiming Angle			
D(ft)	FC	L	W
6	49	9.7	6.0
9	22	14.6	9.0
12	12	19.4	12.0
15	8	24.3	15.0

WTK 502F T4 70W 40 DEG			
0° Aiming Angle			
D(ft)	FC	L	W
6	224	4.4	4.4
9	99	6.6	6.6
12	56	8.8	8.8
15	36	11.0	11.0
45° Aiming Angle			
D(ft)	FC	L	W
6	79	10.2	6.2
9	35	15.3	9.4
12	20	20.4	12.5
15	13	25.5	15.6

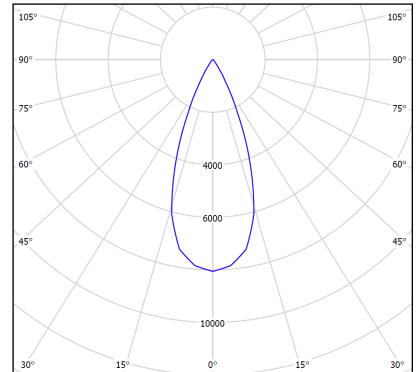
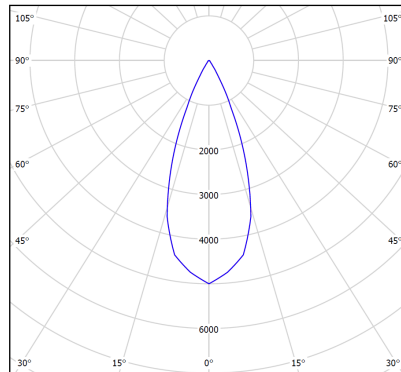
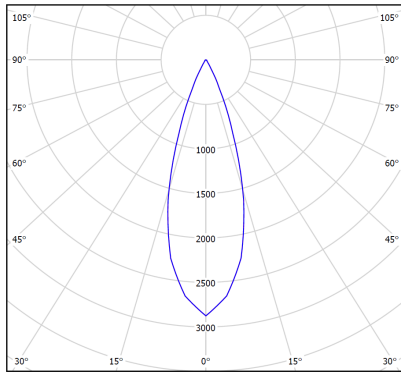

**PALOMA SPOT – METAL HALIDE TRACK HEAD**

**SERIES WHK-502**

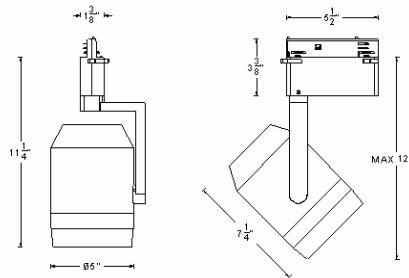

WHK-502-20E\39E

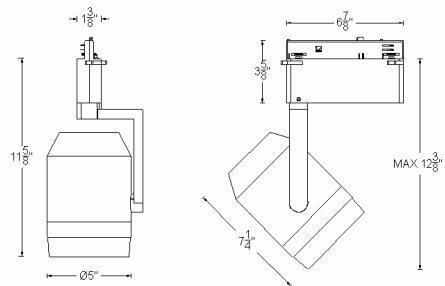

WHK-502-70E

**Ordering Matrix**

Model	Beam Angle	Wattage	Finish
WHK-502	SP = 15° NF = 25° FL = 40°	20E = 20W 39E = 39W 70E = 70W	BK = Black WT = White PT = Platinum

Ordering Example (model-beam-wattage-finish) : WHK-502-FL-39E-PT

**Product Details**

**Description:** Metal Halide track head using T4 HID lamps. Model WHK-502 Designed for use on WAC ARCHITECTURAL tracks(277V). Adaptable to other manufacturer's track. (Consult factory for specific brands).

**Materials:** Die-cast aluminum fixture, cap ring.  
Clear wove 1/8 inch tempered glass lens included.

**Ballast:**

( VS )	ANSI #	20W	39W	70W
		M156	M130	M98 / 139
	Line Current :	0.08A	0.16A	0.28A
	Input Power :	23W	45W	77W
	Input Voltage :	277V	277V	277V
	Power Factor :	> 90%	> 90%	> 90%
	Sound Rating :	A	A	A

**Socket:** Ceramic Bi-Pin HID G8.5

**Aiming:** 365° horizontal rotation and 180° vertical aiming to secure the aiming adjustment on horizontal .

**Lamping:** Re-lamps from the front using T4 HID lamps. 20W ,39W or70W as specified on the fixture. Lamp not included

**Finish:** Powder coat paint finish.  
Available in Black (BK), White (WT), Platinum (PT).

**Listing:** UL & CUL Listed. Patent Pending.

**Specification Features**

- Die-cast aluminum fixture.
- Spring sheet within lens cap allows 4 captive accessories to be held securely.
- The track head utilizes on the WAC ARCHITECTURAL style track (277V).
- 5 year product warranty.

## Compatible Accessories –USE SIZE 30

• **Dichroic Lens**  
LENS-30-DIC-COLOR

• **UV Filter**  
LENS-30-UV

• **IR Filter**  
LENS-30-IR

• **UV- IR Filter**  
LENS-30-UI

• **Beam Elongator**  
LENS-30-BEL

• **Beam Soft/Beam Spread Lens**  
LENS-30-BSL / LENS-30-SPR

• **Block Screen**  
LENS-303-BS/ LENS-304-BS/ LENS-305-BS

• **Hood (for wall-washing)**  
HOOD-30-BK

• **Cross Louver**  
LENS-302-CRL

• **Snoot**  
LENS-30-SNOOT

• **Honeycomb Louver**  
LENS-302-HCL

## Photometry

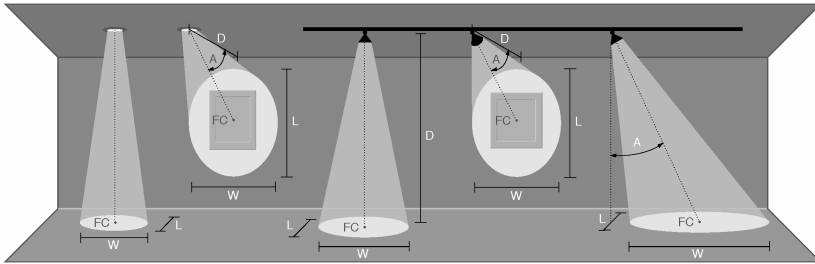

D Distance To Fixture From Wall Or Floor  
FC Initial Footcandle Level At Center Of Beam  
L Beam Length (where candlepower drops to 50% of maximum)  
W Beam Width (where candlepower drops to 50% of maximum)

WHK 502S T4 20W 15 DEG			
0° Aiming Angle			
D(ft)	FC	L	W
6	255	1.3	1.3
9	113	2.0	2.0
12	64	2.6	2.6
15	41	3.3	3.3
45° Aiming Angle			
D(ft)	FC	L	W
6	90	2.7	1.9
9	40	4.0	2.8
12	23	5.4	3.7
15	14	6.7	4.7

WHK 502S T4 39W 15 DEG			
0° Aiming Angle			
D(ft)	FC	L	W
6	587	1.3	1.3
9	261	1.9	1.9
12	147	2.5	2.5
15	94	3.2	3.2
45° Aiming Angle			
D(ft)	FC	L	W
6	208	2.6	1.8
9	92	3.8	2.7
12	52	5.1	3.6
15	33	6.4	4.5

WHK 502S T4 70W 15 DEG			
0° Aiming Angle			
D(ft)	FC	L	W
6	950	1.5	1.5
9	422	2.3	2.3
12	238	3.1	3.1
15	152	3.8	3.8
45° Aiming Angle			
D(ft)	FC	L	W
6	336	3.1	2.2
9	149	4.7	3.3
12	84	6.3	4.3
15	54	7.8	5.4

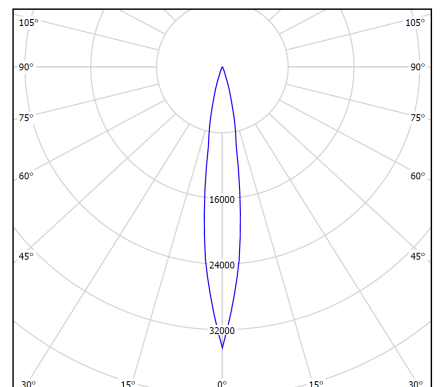
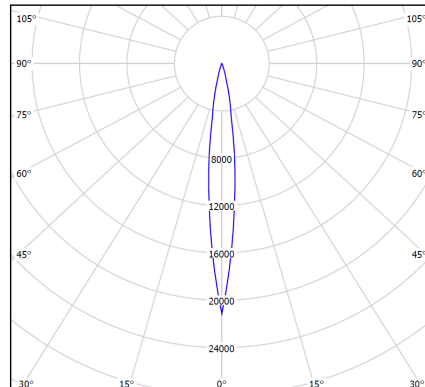
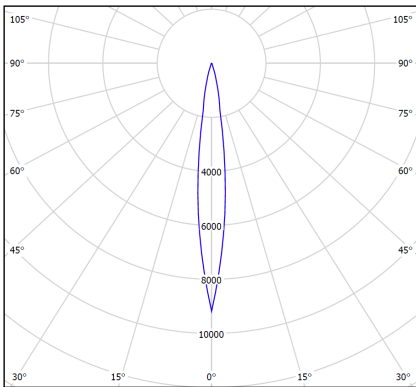

WHK 502N T4 20W 20 DEG			
0° Aiming Angle			
D(ft)	FC	L	W
6	215	1.7	1.7
9	96	2.6	2.6
12	54	3.4	3.4
15	34	4.3	4.3
45° Aiming Angle			
D(ft)	FC	L	W
6	76	3.5	2.4
9	34	5.2	3.6
12	19	7.0	4.8
15	12	8.7	6.0

WHK 502N T4 39W 20 DEG			
0° Aiming Angle			
D(ft)	FC	L	W
6	128	4.4	4.4
9	57	6.6	6.6
12	32	8.8	8.8
15	20	11.0	11.0
45° Aiming Angle			
D(ft)	FC	L	W
6	45	10.2	6.2
9	20	15.3	9.4
12	11	20.4	12.5
15	7	25.5	15.6

WHK 502N T4 70W 25 DEG			
0° Aiming Angle			
D(ft)	FC	L	W
6	469	2.6	2.6
9	208	3.8	3.8
12	117	5.1	5.1
15	75	6.4	6.4
45° Aiming Angle			
D(ft)	FC	L	W
6	166	5.3	3.6
9	74	8.0	5.4
12	41	10.7	7.2
15	27	13.4	9.0

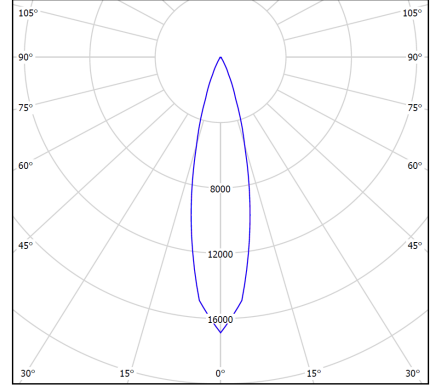
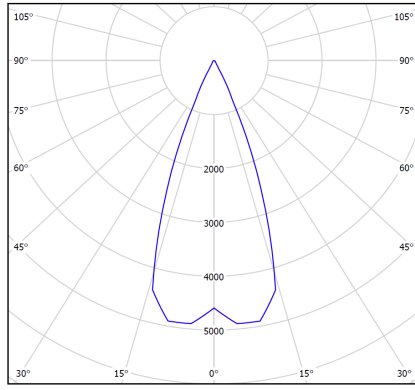
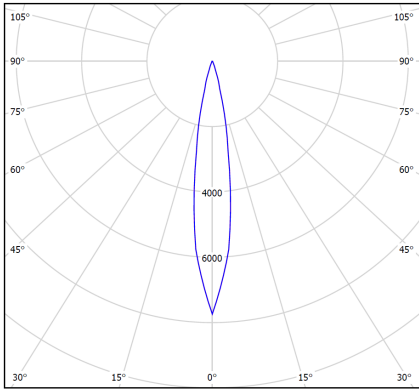

WHK 502F T4 20W 40 DEG			
0° Aiming Angle			
D(ft)	FC	L	W
6	80	3.5	3.5
9	36	5.2	5.2
12	20	7.0	7.0
15	13	8.7	8.7
45° Aiming Angle			
D(ft)	FC	L	W
6	28	7.6	4.9
9	13	11.4	7.4
12	7	15.2	9.9
15	5	19.0	12.3

WHK 502F T4 39W 40 DEG			
0° Aiming Angle			
D(ft)	FC	L	W
6	139	4.2	4.2
9	62	6.4	6.4
12	35	8.5	8.5
15	22	10.6	10.6
45° Aiming Angle			
D(ft)	FC	L	W
6	49	9.7	6.0
9	22	14.6	9.0
12	12	19.4	12.0
15	8	24.3	15.0

WHK 502F T4 70W 40 DEG			
0° Aiming Angle			
D(ft)	FC	L	W
6	224	4.4	4.4
9	99	6.6	6.6
12	56	8.8	8.8
15	36	11.0	11.0
45° Aiming Angle			
D(ft)	FC	L	W
6	79	10.2	6.2
9	35	15.3	9.4
12	20	20.4	12.5
15	13	25.5	15.6

