

INSTALLATION INSTRUCTION

Metal Halide - PAR30 Multiple Spots

MT-130MH, MT-230MH, MT-330MH, MT-430MH

WAC LIGHTING

Responsible Lighting®

CAUTION:

- Always turn off power at the circuit breaker panel or fuse box prior to installation to prevent electrical shock.
- Do not install insulation within 3" of housing.

Designed for installation in dropped grid ceilings or to joist members in new construction ceilings.

NOTE: FOR TRIMLESS INSTALLATION, PLEASE INSTALL THE BRACKET WITH SCREWS PROVIDED.

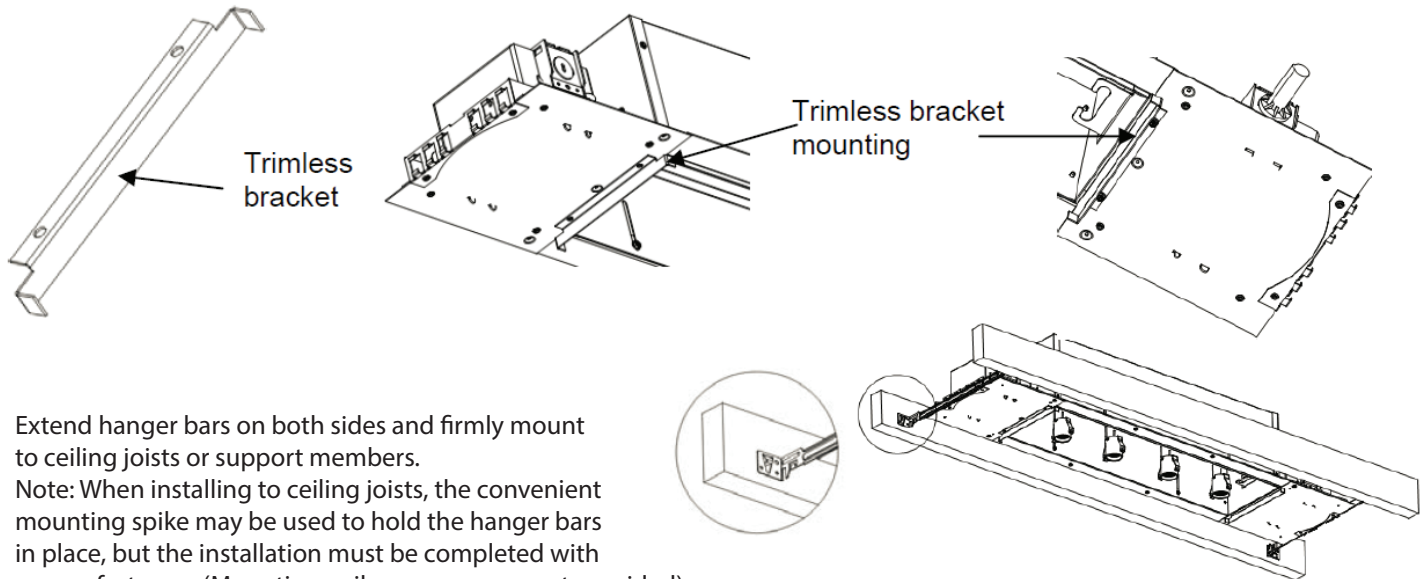

1. Extend hanger bars on both sides and firmly mount to ceiling joists or support members.
Note: When installing to ceiling joists, the convenient mounting spike may be used to hold the hanger bars in place, but the installation must be completed with proper fasteners (Mounting nails or screws are not provided).
2. Draw supply wire (1/2" trade size flexible metal conduit or non-metallic sheathed cable) from ceiling to fixture site.
3. To make electrical connections:
 - a. Route supply wire to junction box opening with suitable connector.
 - b. Connect black wire to black supply wire with wire nut.
 - c. Connect white wire to white supply wire with wire nut.
 - d. Connect Green grounding wires with wire nut. (Wire may be green or un-insulated)
 - e. Close junction box cover.
4. Install ceiling.
5. Use template supplied to make appropriate cutout for trim installation.

TO INSTALL TRIM

- a. Raise the trim to the housing and place socket from housing to back of trim as shown in the trim hole and depress socket springs to clip in place.
- b. Attach by securing the torsion springs and guiding them through the anchor cleats.
- c. Push trim flush up against the ceiling and install HID PAR30 lamps.

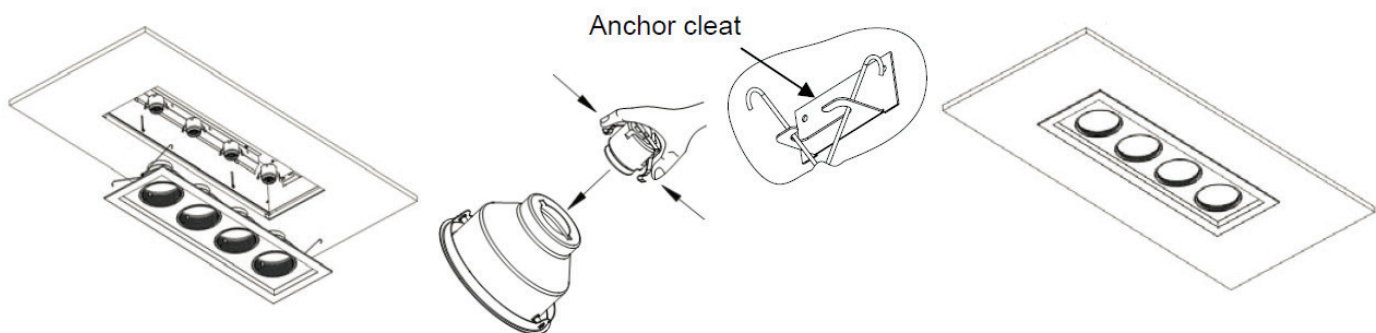

WAC Lighting
www.waclighting.com
Phone (800) 526.2588 • Fax (800) 526.2585

Headquarters/Eastern Distribution Center
44 Harbor Park Drive • Port Washington, NY 11050
Phone (516) 515.5000 • Fax (516) 515.5050

Western Distribution Center
1750 Archibald Ave • Ontario, CA 91761
Phone (800) 526.2588 • Fax (800) 526.2585

INSTALLATION INSTRUCTION

Metal Halide - PAR30 Multiple Spots

MT-130MH, MT-230MH, MT-330MH, MT-430MH

WAC LIGHTING

Responsible Lighting®

TRIMLESS INSTALLATION:

Note: For trimless installation, please install the bracket with screws provided.

- Raise screen panel to ceiling opening and secure with screws supplied.
- Apply plaster over screen panel and sand surface when dry for a finish look.

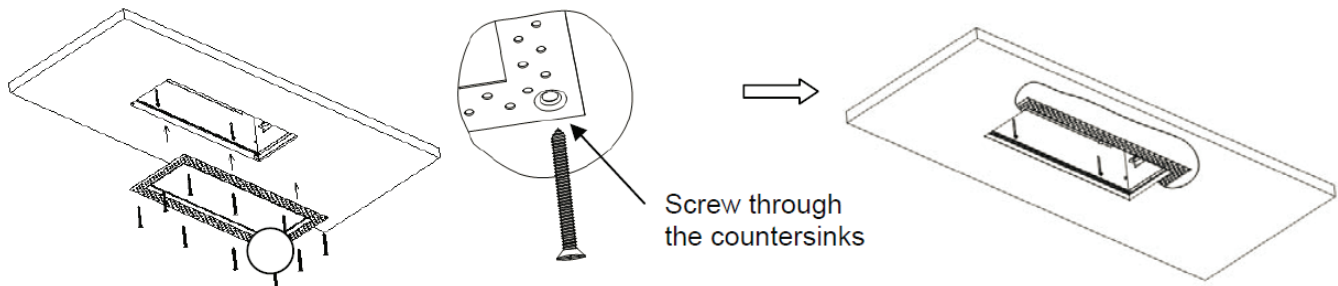

- Raise the trim to the housing and place socket from housing to back of trim as shown in the trim hole and depress socket springs to clip in place.
- Attach by securing the torsion springs and guiding them through the anchor cleats.
- Push trim flush up against the ceiling and install HID PAR30 lamps.

TO SERVICE BALLAST

Gain access to the junction box, by removing the 4 screws securing housing shell, and pulling down or pushing aside enough to allow sufficient hand space.

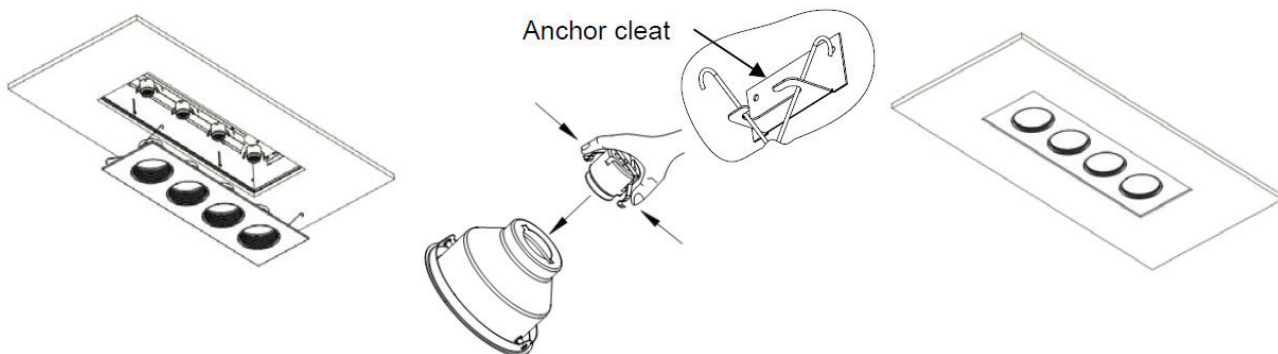

Retain instructions for maintenance reference.

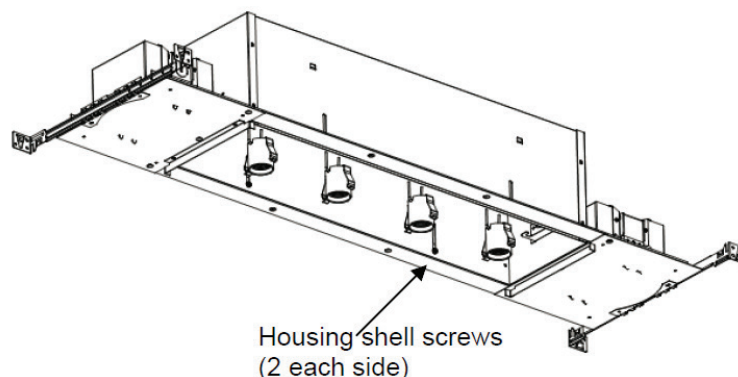

WAC Lighting
www.waclighting.com
Phone (800) 526.2588 • Fax (800) 526.2585

Headquarters/Eastern Distribution Center
44 Harbor Park Drive • Port Washington, NY 11050
Phone (516) 515.5000 • Fax (516) 515.5050

Western Distribution Center
1750 Archibald Ave • Ontario, CA 91761
Phone (800) 526.2588 • Fax (800) 526.2585