

# INSTRUCTIONS: Model: QP-701 Pendant Socket Set

## INSTRUCTIONS PERTAINING TO A RISK OF FIRE, OR INJURY

Lighted lamp is HOT!

### WARNING - To reduce the risk of FIRE OR INJURY:

- Turn off all power and allow to cool before replacing lamp.
- Lamp gets HOT quickly! Contact only switch/plug when turning on.
- Do not touch lens, guard, or enclosure.
- Keep away from materials that may burn.
- Do not touch the lamp at any time. Use a soft cloth. Oil from skin may damage lamp.
- Do not operate the luminaire with a missing lens or damaged shield.
- Save these instructions.

**Overview:** Pendant sockets sets are designed for use with all WAC quick connect adapters. They may also be used on other manufacturers brand of quick connect (consult factory for compatibility). Pendants may be mounted to monorail, mono/multi points, or line volt track, by coupling to a low voltage quick connect adapter. Sockets are supplied with a 6' cable and may be field cut to desired length.

### Installing Lamp & Shade:

1. Insert the lamp into the socket by aligning the pins with the socket holes, and gently pushing until lamp seats. Use 12V 50W Xenon (not tungsten halogen) bi-pin G 6.35 base, lamp(supplied) ( 24V lamp may be used depending on power supply).

For replacement lamp information visit our website [www.waclighting.com](http://www.waclighting.com)

2. Attach the inner shade by twisting and pushing in one continuous motion over the spring band.
3. Place the outer shade over the socket and small shade. Raise the ring to the desired height and thread the three support rods into the ring.
4. Tighten rods to secure the height.

### Installing Pendant to Quick Connect:

1. Insert the post of the quick connect into the quick connect adapter.
2. Thread the top half of the conical section until it seats with the adapter.

See p.2 for field shortening pendants.

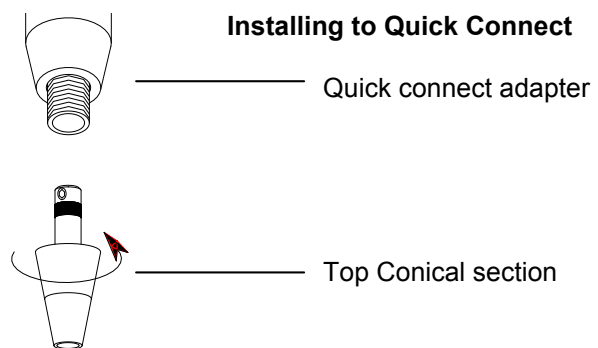
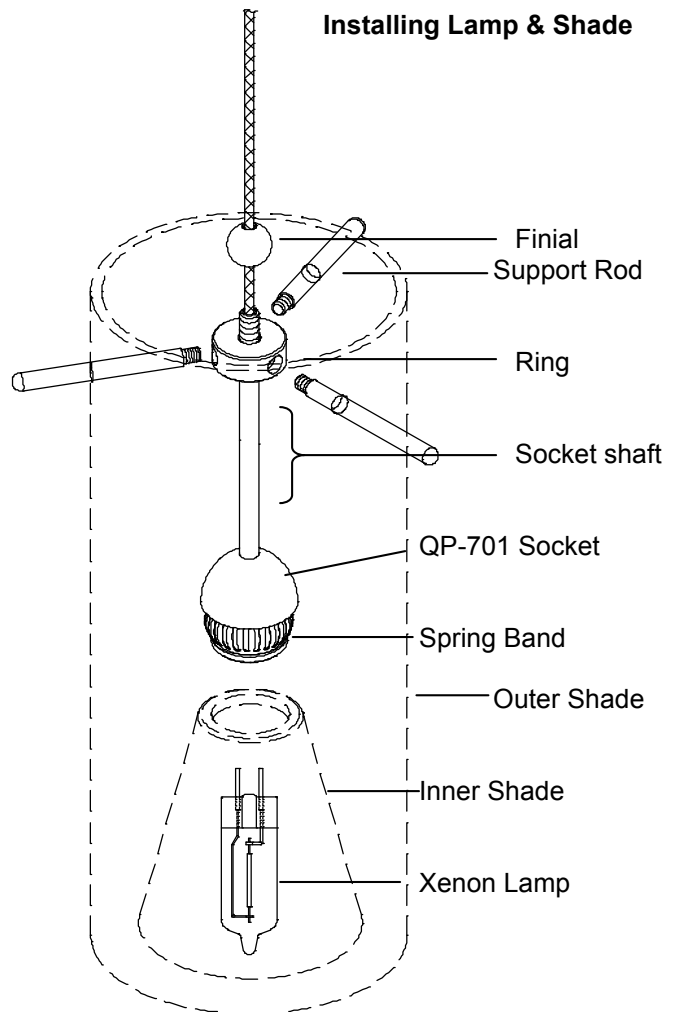

### To Install/ Shorten Pendant:

All Pendant shades use the quick connect adapter to attach to the rail. On the QP-701 the mating piece (top conical section) for quick connect adapter comes uninstalled. Feed the cable end through the glass shade and the metal finial. If cable needs to be shortened, make the cut now. To install the top conical section, follow the step-by-step instructions below. **NOTE: Pendant cables are co-axial, if the lower screw in step 4 is made too tight, the inner an outer wire will short. A short circuit will render the entire system in-operative and possibly damage the transformer. Check all pendant splices for continuity before installing.**

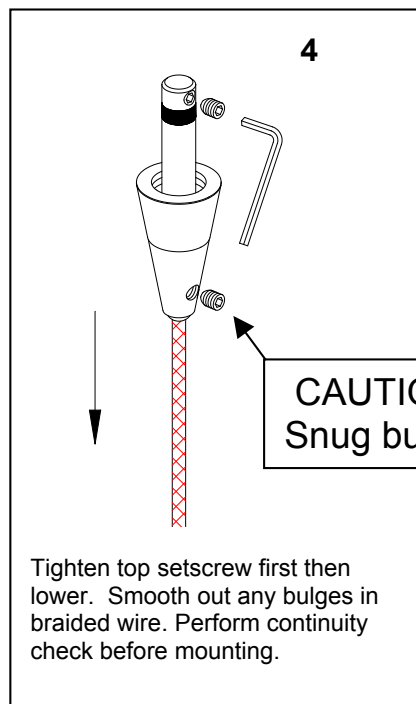
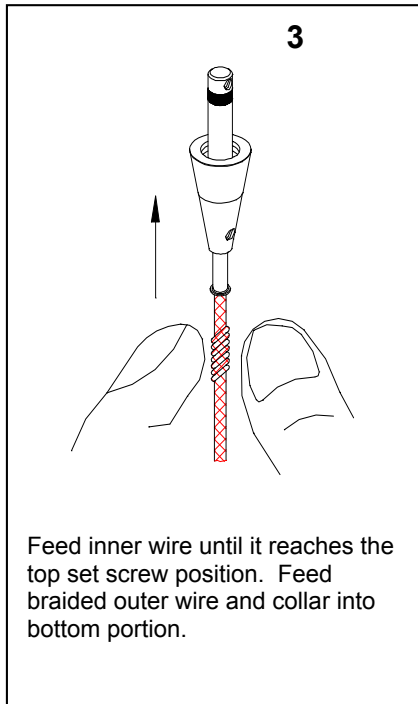
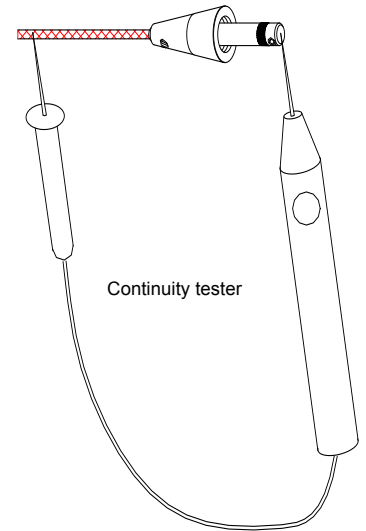
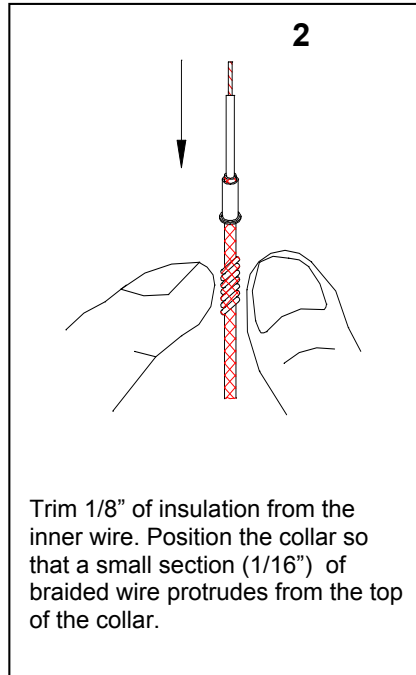
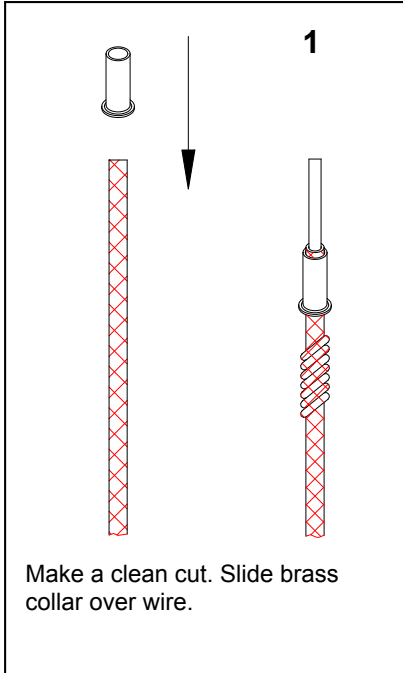

#### Check Splice:

Before mounting, with lamp removed from the socket, check for continuity. There should be none.

Insert lamp in socket and re-check. There should now be continuity, indicating a completed circuit.

Install with power off.